

TYPICAL PLAN FOR INDUSTRIAL RADIOGRAPHY ENCLOSURE (CLOSED TOP) FOR PANORAMIC EXPOSURE USING 100Ci Co-60 SOURCE

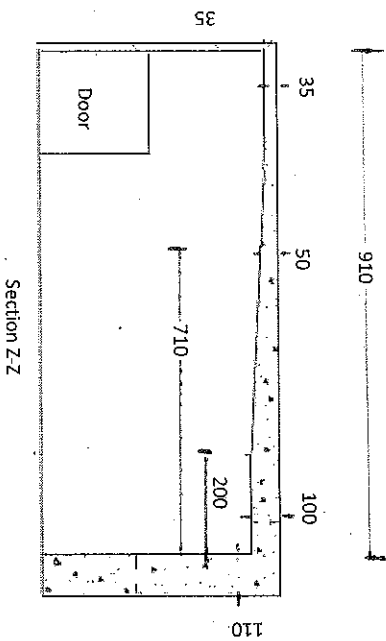

- Assumptions
1. Full Occupancy
  2. Workload of 30hrs/week
  3. Public occupancy

TYPICAL PLAN FOR INDUSTRIAL RADIOGRAPHY ENCLOSURE (CLOSED TOP) FOR PANORAMIC EXPOSURE USING 100Ci Ir-192 SOURCE

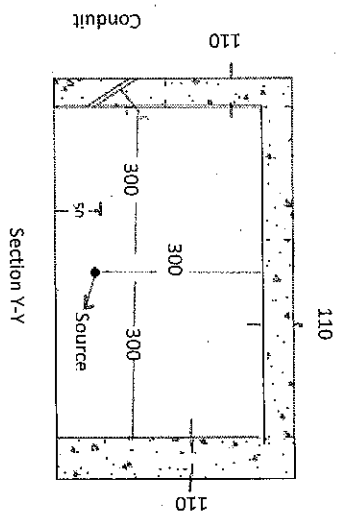
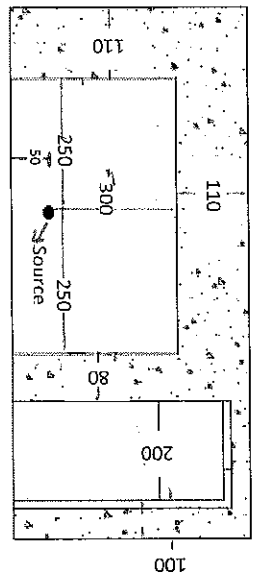
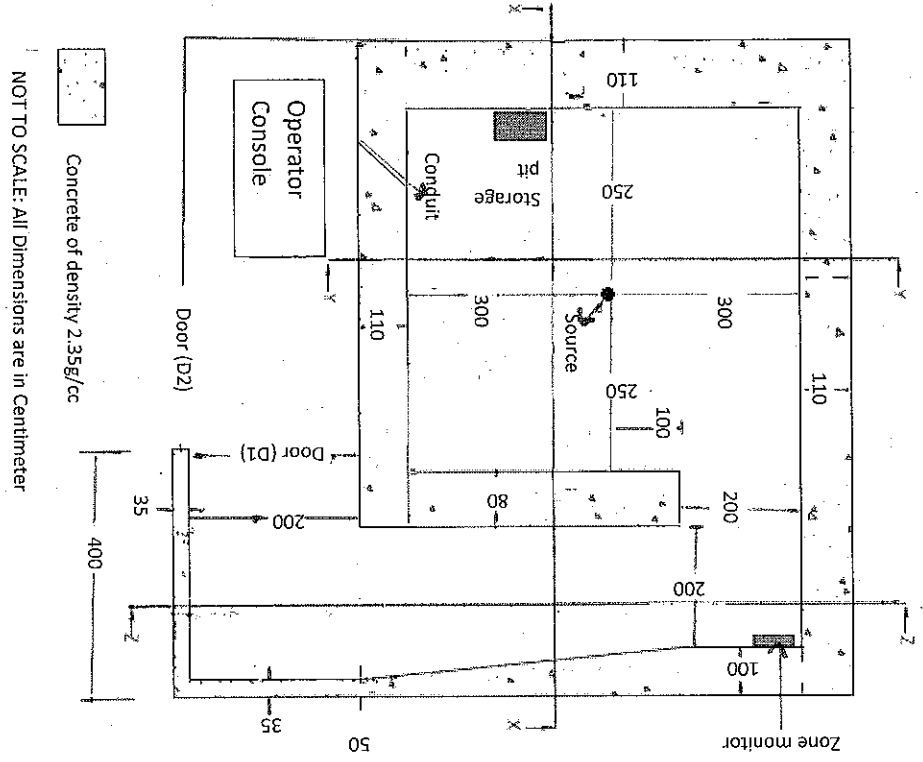
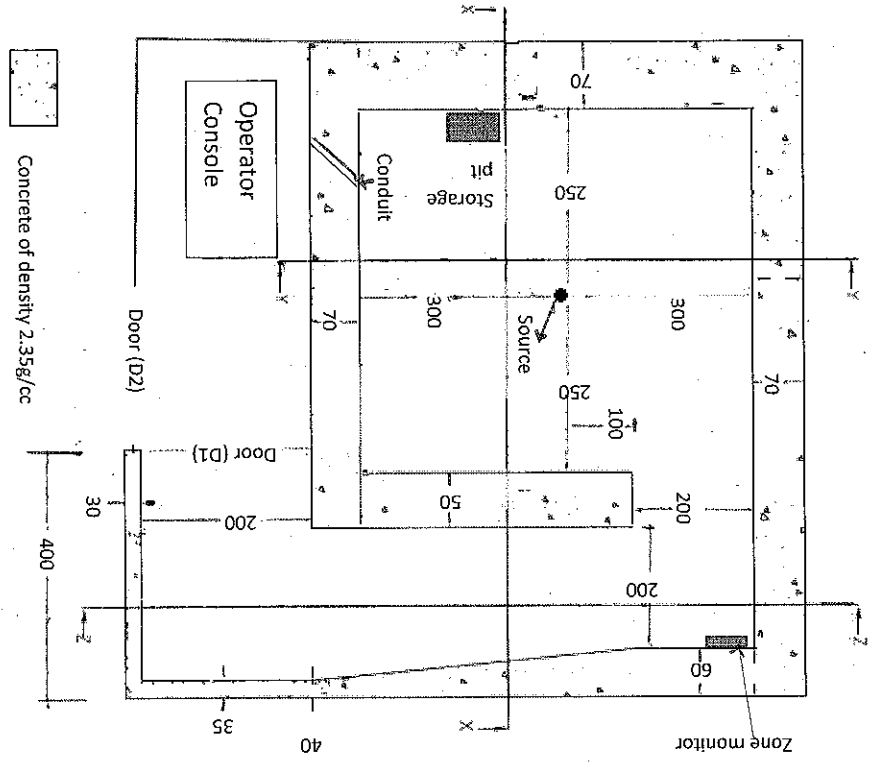

NOT TO SCALE: All Dimensions are in Centimeter

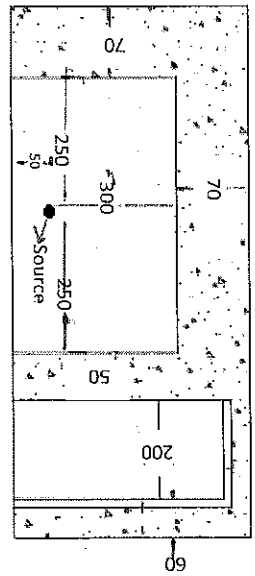

Section X-X

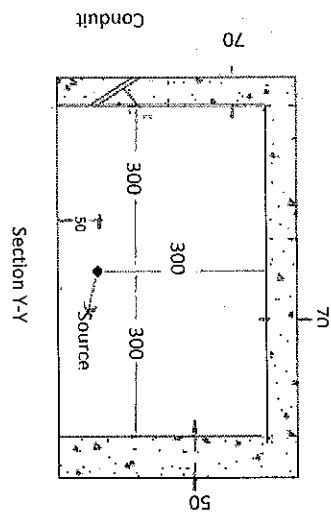

Section Y-Y

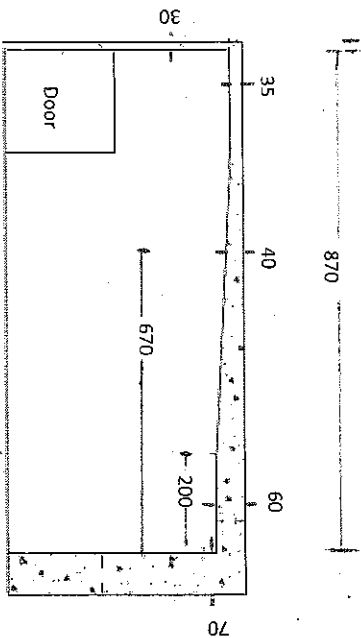

Section Z-Z

Assumptions

1. Full Occupancy
2. Workload of 30hrs/week
3. Public occupancy